

Manual

Earth auger

1 400 W

1.9 Hp

Power

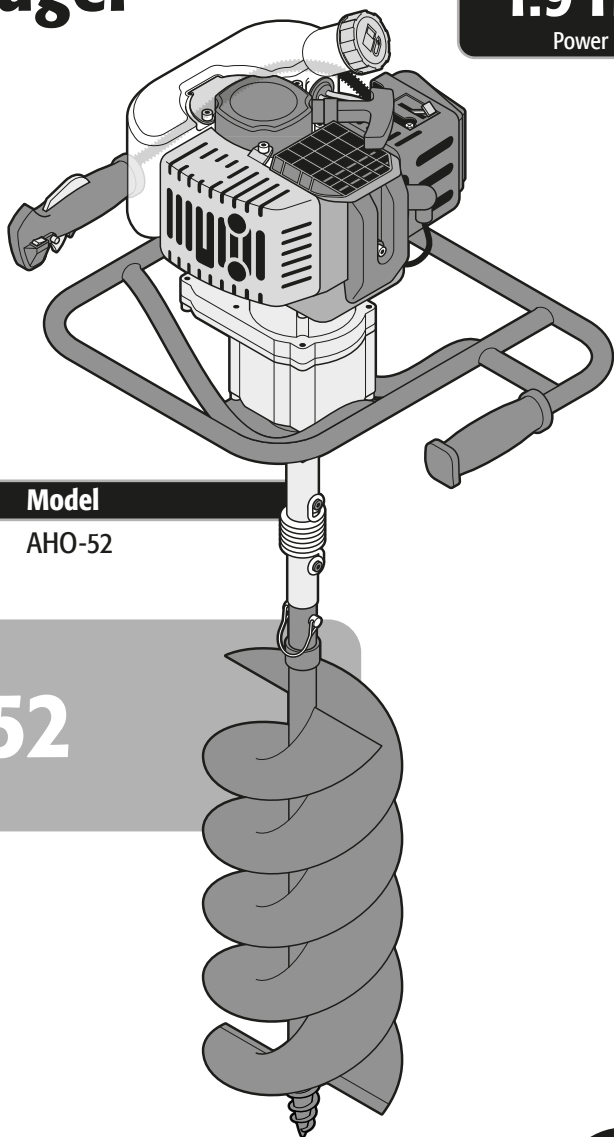

Applies for:

Code

103204

Model

AHO-52

AHO-52

CAUTION



Read this manual thoroughly
before using the tool.



Technical data	3
Fuel requirements	3
 General motor tool safety warnings	4
 Safety warnings for the use of earth augers	5
Parts	6
Assembly	7
Fuel supply	8
Start up	8
Operation	9
Maintenance	10
Troubleshooting	11
Accessories and spare parts	12
Notes	12
Authorized service centers	13
Warranty policy	14

CAUTION

To gain the best performance of the tool, prolong the duty life, make the Warranty valid if necessary, and to avoid hazards of fatal injuries please read and understand this Manual before using the tool.

Keep this manual for future references.

The illustrations in this manual are for reference only. They might be different from the real tool.

Use and care recommendations

 For better performance and durability, use high-octane gasoline. In Mexico, we recommend using **PREMIUM** gasoline mixed with **2-STROKE ENGINE OIL**. Using the wrong mixture can cause serious engine damage.

 +  = **50:1**
4 capfuls oil Gasoline PREMIUM Mix

 **DO NOT** use **GASOLINE MIXTURE** that has been stored for over 15 days.

 **ALWAYS** run your machine at **FULL POWER** with the throttle **FULLY** engaged.

 Keep the engine's ventilation slots **CLEAR**.



 Perform regular **MAINTENANCE** on your machine (Page 10 and 11).

AHO-52

Code •	103204
Description •	Earth auger
Engine power •	1.9 Hp (1 400 W)
Engine displacement •	52 cm ³ (cc)
Fuel tank •	1 L (34 oz)
Auger diameter •	20 cm (8")
Auger length •	55 cm (21")
Speed •	7 000 RPM
Duty cycle •	30 minutes of rest per tank consumed. Maximum 6 hours daily.

Fuel requirements

- The auger has an air-cooled 2-stroke engine that uses a mixture of unleaded gasoline and high-quality self-mixing oil with a specified fuel stabilizer for air-cooled 2-stroke engines.
- The engine is certified to operate with unleaded gasoline for vehicles with an octane rating of 87 ((R+M)/2) or higher.
- Do not use any type of pre-mixed gasoline with oil purchased at gas stations, such as that intended for motorcycles.
- Do not use automotive-use oil or 2-stroke outboard motor oil.
- The mixture ratio should be 50 parts gasoline to 1 part oil (50:1 ratio). Prepare the mixture in an approved gasoline container. Always mix well before pouring it into the engine tank.

⚠ CAUTION Do not use fuel mixture stored for more than 15 days. Make the mixture in small quantities.

⚠ WARNING Never smoke near the fuel or in the area where you refuel with gasoline or prepare the oil mixture, or while operating the auger.

⚠ WARNING Any attempt to start the auger without adding oil to the fuel mixture will cause engine failure.



Use TRUPER ACES-2, ACES-5 or ACES-20 oil caps** to measure the mix.
Mix 5 capfuls oil per each gasoline liter.



A wrong mix may cause the motor to throw a rod causing expensive repairs!



4 capfuls oil



Gasoline
PREMIUM



50:1

Mix

To prolong the useful life of the motor use TRUEPR two-cycle synthetic motor oil.

* 1 gallon = 3.78 liter

** Not included

General motor tool safety warnings

Keep your work area clean, tidy and well lit.

CAUTION Cluttered and dark areas may cause accidents.



Never use the tool in explosive areas or in the presence of flammable liquids.

DANGER Before starting the motor keep the tool at least 9 meters (30 feet) away from the fill up area.



Keep children and passersby at a safe distance while operating the tool.

WARNING Distractions could cause losing control and cause accidents.



Avoid contact with power lines and circuits.

DANGER Find and avoid power lines and circuits, especially hidden wiring as well as any grounded object.



Stay alert, use care and common sense.

CAUTION Familiarity with the tool operation could lead to distractions. It could cause accidents.

Refrain from using the tool if tired or under the influence of drugs, alcohol or medication.

DANGER Being momentarily distracted while using the tool could cause severe personal injury.

Operate the tool with guards and protection devices in place and in good working condition.

WARNING Failure to comply with this warning is a hazard of severe personal injury.

Do not force the tool.

CAUTION Working within the tool's working design assures a better and safer job.



Keep the tool in a safe place and out of the reach of children.

WARNING Motor powered tools are dangerous to inexperienced people.



Wear proper clothes.

WARNING Loose clothes, jewelry or long hair could get caught in the mobile parts.



Keep hands away from rotating and/or mobile parts.

WARNING Failure to comply with this warning is a hazard of severe personal injury.



Do not operate the tool in enclosed areas.

DANGER Avoid breathing accumulated carbon monoxide, a potentially deadly odorless toxic gas.



Wear adequate protective safety accessories.

CAUTION Wear eye protection, dust mask, non-skid safety shoes, helmet and ear plugs. These safety gears reduce the risk of injury.



Turn off the tool before adjusting, changing accessories or storing.

WARNING Double check the tool switch is in the off position.

Refrain from operating the tool if the switch is not working or is not properly assembled.

WARNING Failure to comply with this warning is a hazard of personal injury. Immediately send it to a **TRUPER** Authorized Service Center.

Do not overreach.

CAUTION Good balance and support lead to better controlling the tool in unexpected situations.

Avoid the tool to unintentionally start.

WARNING Double-check the tool motor is off before maintenance or putting it away.



Remove brackets before turning on the tool.

DANGER Additional tools or vices installed in a rotating part could cause severe personal injury.

Service the tool and double-check it is in good working conditions before operating.

CAUTION Carefully check mobile parts, alignment and assembly. Do it periodically. Look for any damaged element or part not working properly. Repair immediately in a **TRUPER** Authorized Service Center.



Accessories.

CAUTION Use only accessories or spare parts indicated in this Manual or certified by **TRUPER**.

Never leave a running tool unattended.

DANGER Turn off and disconnect the tool after using. Set it in a safe position to avoid severe injury.

Never smoke in the proximity of fuel.

DANGER Do not smoke in the proximity of the fueling area or when using the tool.



Do not touch parts with high temperatures.

The surface of the engine and the exhaust reach high temperatures during the operation of the tool.



Service and repair.

Always go to a **TRUPER** Authorized Service Center to use identical spare parts and maintain the security of the tool.

Safety warnings for the use of earth augers

TRUPER®

Fuel handling

- Never smoke near the fuel, the refueling area, the oil mixture preparation area, or when operating the tool. 
- To reduce the risk of fire or burns, handle fuel carefully; it is highly flammable. 
- Do not allow gasoline or oil to meet the skin.
- Protect your eyes to avoid splashes of gasoline and oil. In case of accidental contact, wash them immediately with clean water. If irritation persists, seek medical attention.
- Mix and store fuel in a container designed for that purpose.

⚠ WARNING • Mix the fuel outdoors away from any sparks or flames.

- Before refueling the auger, turn off the engine, place it on clear ground, and wait for the engine to cool.

⚠ CAUTION • Clean any spilled fuel on the auger before operating it.

⚠ CAUTION • Check for fuel leaks, and if found, correct them before using the auger to prevent fires or burn injuries.

- Keep the auger at least 30 feet (9 meters) away from the fueling area before starting the engine.
- Under no circumstances burn spilled fuel to dispose of it.
- Never use any other type of fuel than that specified for the auger in this manual.

Before operating the earth auger

- Equip yourself with appropriate clothing for operating the auger: tight-fitting clothes, thick pants, slip-resistant safety boots, heavy-duty protective gloves, and safety glasses with side protection under ANSI Z87.1 standard.



⚠ WARNING • Remove any accessories or loose clothing that could be caught by the moving auger. Tie back hair so that it is above shoulder level.

- Ensure that the auger is in perfect condition. Do not start it if it is poorly adjusted, not fully assembled to function safely, or if the fuel tank has a leak or any loose screws.
- Ensure that the auger stops moving when releasing the throttle trigger. If it does not stop, turn off the auger and consult a **TRUPER**® Authorized Service Center to address the issue.
- Ensure that the auger is clean, dry, and free of oil or fuel.
- Ensure that the work area is open and well-ventilated.
- Check the work area and remove any stones, broken glass, nails, wire, or rope, as they could be thrown or entangled in the auger.
- In extreme temperatures, check for ice formations or condensation on the tool.
- Visibility and lighting conditions should be adequate to see clearly; otherwise, do not use the auger.
- Do not use the auger without guards or if they are damaged or missing any parts.

When operating the earth auger

⚠ CAUTION • Keep pedestrians, children, and animals at least 15 meters away.

- Ensure that the auger is not in contact with any object before starting the engine.

⚠ WARNING • Keep both feet firmly on the ground and both hands gripping the handles. Never operate it with one hand, as this could result in injuries to the operator and others present.

- Keep all parts of the body away from the auger when the engine is running.

• Always keep the auger pointing downward, below your waist level, and never lift it over your shoulders level.

- Keep all body parts away from the muffler, it can cause serious burns.

• Keep the auger away from flammable materials.

- Be aware of risks in your surroundings; the noise from the auger may prevent you from noticing them.

After operating the earth auger

⚠ WARNING • Do not attempt to stop the rotating movement of the auger in any way other than releasing the switch. Wait for it to stop on its own after turning off the auger; this will take a few seconds.

⚠ CAUTION • Always move the auger with the engine off and keep the muffler away from the body. Before loading it onto a vehicle, empty the fuel tank.

⚠ WARNING • Turn off the engine before setting the auger aside. Do not leave the engine running unattended. Let it cool down before storing it.

⚠ CAUTION • Service and repair of the earth auger should only be performed by highly trained personnel, seek for a **TRUPER**® Authorized Service Center.

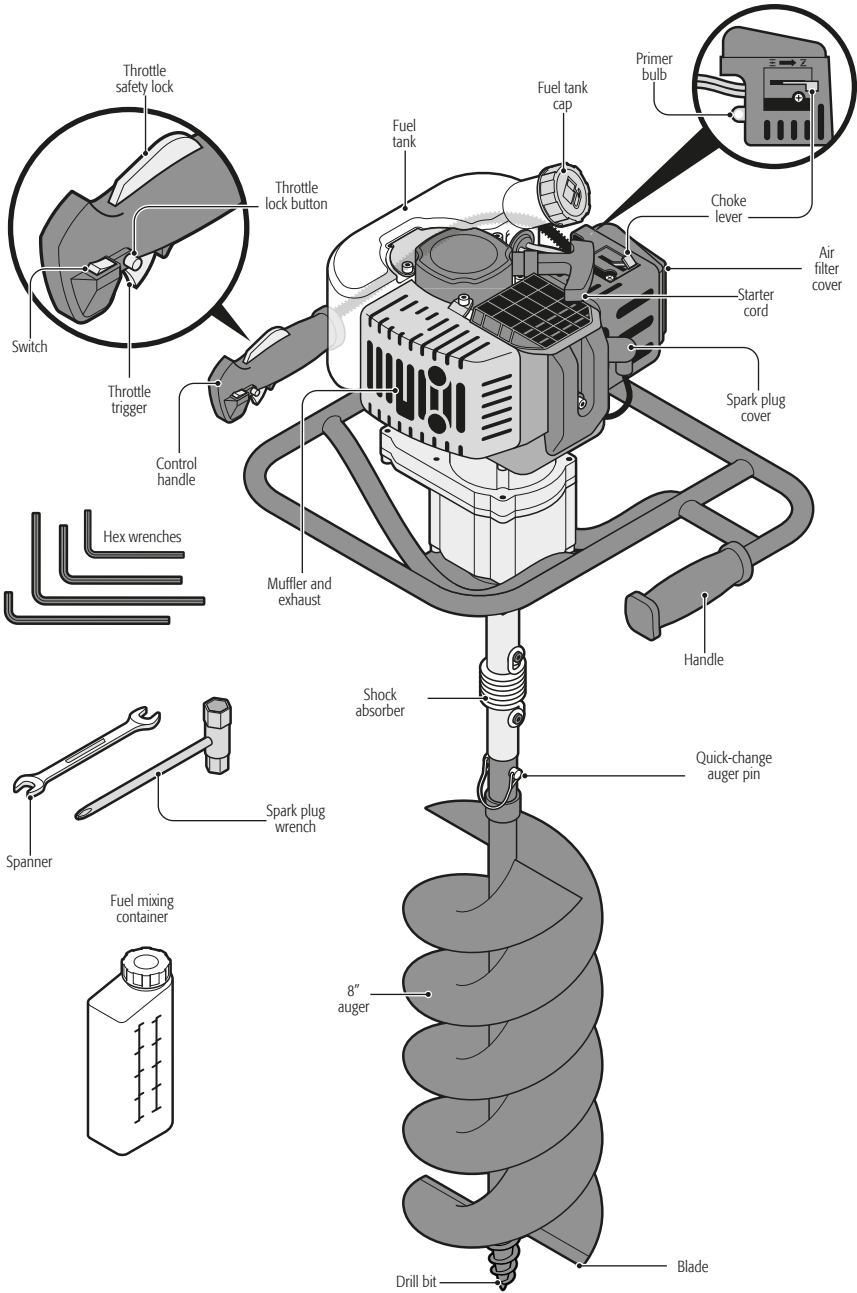

Shaft connection

- Place the equipment on the ground as shown in the image.
- Insert the shaft (A) into the shock absorber (B) and the shock absorber into the auger (C).

Note: Align the arrow hole with that of the shock absorber and the shock absorber with that of the auger.

- To secure the connection between the shaft and the shock absorber, insert the quick-change auger pin (F) through the holes.

- To secure the shock absorber and the auger connection, insert the quick-change auger pin (F) through the holes.

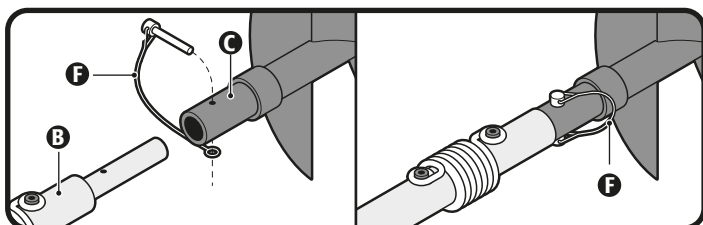
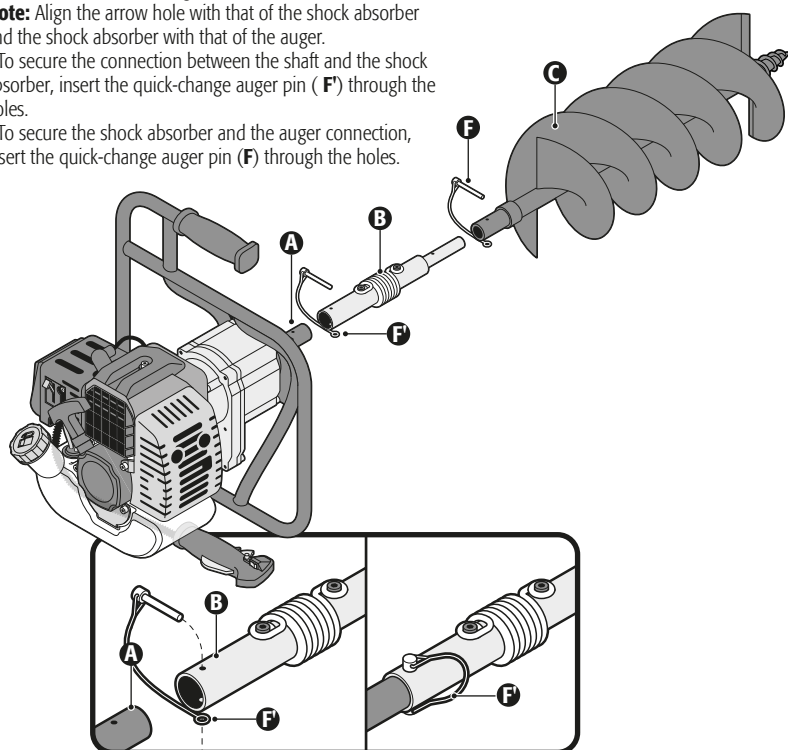

- Follow the safety guidelines for fuel handling (page 5).
- Wait for the engine to cool completely before refueling.
- Place the tool on a flat surface, leaning it as indicated in the diagram.
- Clean around the fuel tank cap to prevent contamination.
- Loosen the fuel tank cap slowly.
- Carefully pour the fuel mixture into the tank, avoiding spills. **CAUTION** Follow the fuel specifications (page 3).
- Before closing the fuel tank, check and clean the gaskets.
- Immediately replace the fuel tank cap and tighten it by hand.
- Clean any fuel spills.

CAUTION In a new engine, it is normal to have smoke emissions during and after the first use.

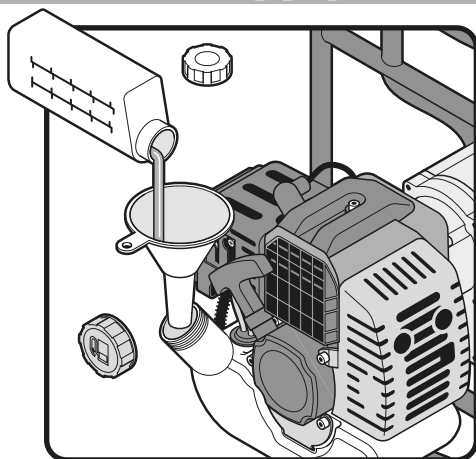

Start up

Engine startup

- Firmly grip the equipment by the auxiliary handle while positioning the drill vertically on the drilling ground.
- Set the switch to the ON position (A).
- If the engine is cold, move the choke lever (B¹) to the CLOSED position . Press and release the primer bulb 6 times (C) or until fuel circulates through the hoses leading to the carburetor.
- If the engine is hot, move the choke lever (B²) to the OPEN position and do not use the primer bulb.

Note: For a cold start, the choke must be in the CLOSED position, and for a hot start, the choke must be OPEN.

- Pull the starter (D) quickly to start the engine. Once the engine starts, do not release the starter; carefully return it to its initial position to avoid damage.
- For a cold engine, after starting, move the choke lever to the OPEN position (B²).
- Allow the engine to idle for a few seconds.
- Hold the tool by both handles with both hands to begin work.

WARNING Keep both feet firmly planted on the ground and both hands holding the tool by both handles.

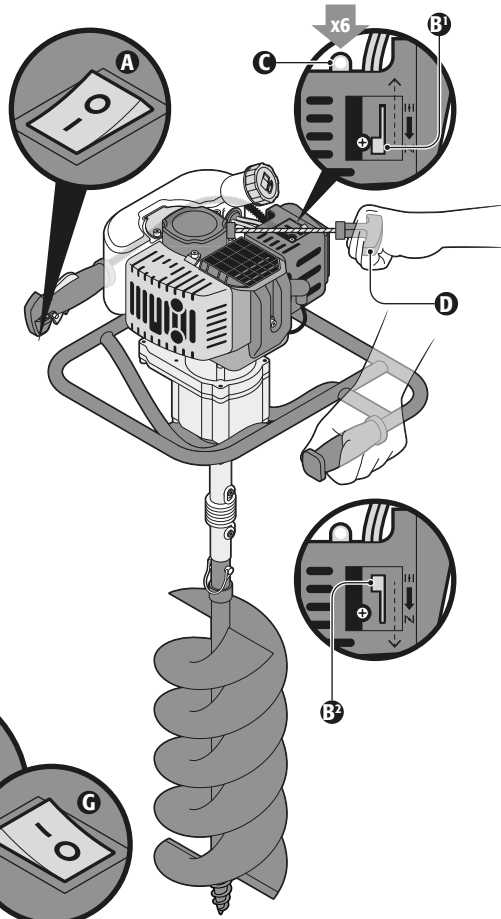

Engine shutdown

- Release the safety lock (E) and the throttle trigger (F).
- Set the switch to the OFF position (G).

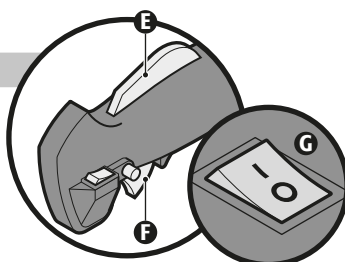

- Keep a stable posture. Separate your feet to align them with your shoulders.
- Hold the auger with both hands. Your thumbs and fingers should grip the handles to ensure a proper hold. Your right hand holds the control handle and presses the safety lock (A) with the palm to activate the throttle trigger (B).
- Keep all parts of your body away from the auger when the engine is running.
- Place the bit at the point where you want to work and start drilling.

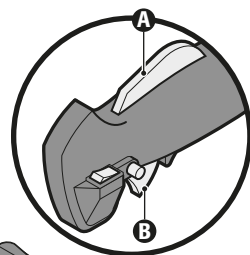

Drilling

- Press the throttle to start the auger spinning.
- Firmly hold the equipment by both handles in a vertical position on the ground without losing the vertical.
- Insert the auger into the ground to the required depth.
- Keep the auger rotating to remove it from the drilled hole.

⚠ CAUTION • Be alert for any kickback that may occur if the auger encounters an obstacle.

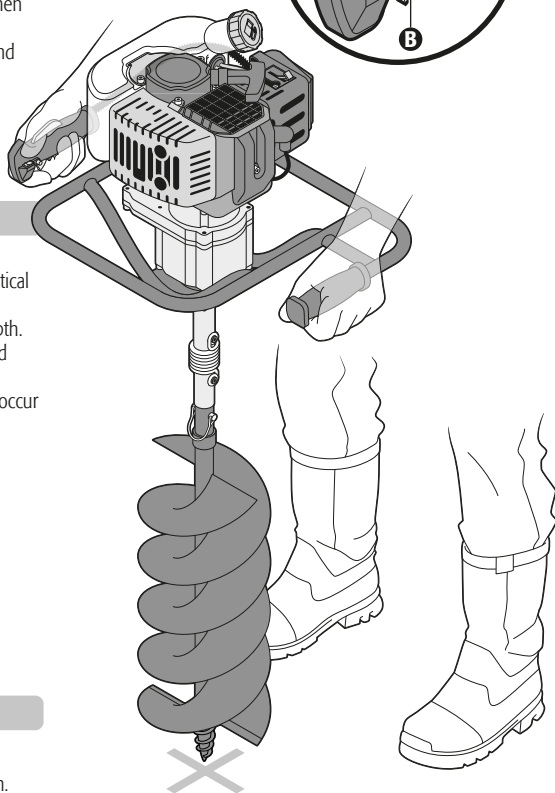

Vibration

To reduce the risk of vibration injuries:

- Wear anti-vibration gloves to keep your hands warm.
- Keep the auger blades and drill in good condition. Dull blades will increase cutting time and vibrations transmitted to your hands.
- Maintain a firm grip at all times but do not constantly grip too tightly; take frequent breaks.
- All these precautions do not eliminate the risk of vibrations-related injuries or illnesses, such as carpal tunnel syndrome. Therefore, all operators should pay attention to their hands and fingers condition. If any discomfort appears, seek for medical attention and avoid using the equipment.

- Before inspecting, cleaning, or servicing the tool, turn off the engine, wait for all moving parts to stop; disconnect the spark plug cord and separate it from the spark plug. Otherwise, you may suffer serious injuries due to accidental equipment start.

General cleaning

- Use a brush or compressed air to clean and clear the ventilation slots of the starter unit whenever necessary.
- Periodically clean the engine cylinder fins and fan fins to remove any impurities. Failure to do so may cause the engine to overheat.

Air filter cleaning

- Remove the air filter cover by loosening the cover screw.
- Remove the air filter.
- Depending on usage time, you can give the filter a superficial cleaning by tapping it lightly on a smooth, flat surface to dislodge most particles.
- Alternatively, blow the filter with compressed air from both sides.
- For a more thorough cleaning, wash the air filter in warm soapy water, rinse it, and let it dry completely before reinstalling it in.
- Reinstall the air filter, ensuring it fits securely in place.
- Clean the air filter as often as needed to keep it consistently clean; otherwise, the engine's efficiency may decrease.

Fuel filter

- Regularly check the gasoline filter.
- If the filter is dirty, it should be replaced.
- If the inside of the gasoline tank is dirty, rinse it with gasoline.

Carburetor adjustment

- It is recommended to have carburetor adjustments done at a **TRUPER** Authorized Service Center.
- Incorrect adjustment can damage the engine and void the warranty.

Tool storage

If you plan to store the tool for a month or more, consider the following:

- Drain all fuel from the fuel tank into an approved gasoline container. Any excess should be reused in another two-stroke engine equipment with a 50:1 ratio.
- Run the engine until it consumes the remaining fuel and shuts off on its own to eliminate residual fuel and prevent the formation of clumps that could damage the fuel system.
- Clean the tool thoroughly.
- Store the unit in a ventilated space, away from corrosive agents such as garden chemicals or ice-melting salts, and out of reach of children.
- Comply with all government safety regulations for handling and storing fuels.

Spark plug replacement

- The engine uses a Champion RCJ-6Y spark plug with an electrode gap of 0.63 mm (0.025"). Replace the spark plug with an identical new one once a year.
- With the engine completely cold, loosen the worn spark plug to the left with a wrench and remove it.
- Insert the new spark plug and hand-tighten it to the right.

⚠ CAUTION • Be careful not to damage the spark plug thread; otherwise, serious damage to the engine may occur.

Exhaust and muffler cleaning

- The exhaust and muffler may become clogged with carbon deposits, depending on the type of fuel, amount of oil used, and/or usage conditions. If you notice a loss of power, these deposits should be removed to restore performance. Visit a **TRUPER** Authorized Service Center to perform this service.
- The muffler is equipped with a spark arrester screen inside. After extended use, the screen becomes dirty and the muffler should be replaced. Visit a **TRUPER** Authorized Service Center to perform the replacement.

⚠ CAUTION • Continuously check that the muffler is properly secured with fasteners and that there is no damage or corrosion. If a leak is found, stop the tool and immediately take it to a **TRUPER** Authorized Service Center for repair.

Lubrication

- The inside of the gearbox is lubricated with multi-purpose lithium-based grease. Visit a **TRUPER** Authorized Service Center to replace the grease every 50 hours of use.
- Insert the new grease through the grease valves located in the gearbox.

Periodic maintenance	After each use	Every 25 hr of use	Every 50 hr of use	Every 150 hr of use	Every 250 hr of use
General cleaning					
Air filter cleaning					
Gearbox lubrication*					
Carburetor cleaning*					
Spark plug inspection and adjustment*					
Fuel tank cleaning**					
Fuel filter replacement**					
Fuel hose replacement**					
Combustion chamber cleaning**					

*Trained user or **TRUPER®** Authorized Service Center

** **TRUPER®** Authorized Service Customer Center

Troubleshooting

Problem

Cause

Solution

The engine does not start.

- No spark.
- No fuel.
- Flooded engine.
- The starter cord pulls with more difficulty than when it was new.

- Check the spark. Remove the engine cover. Take out the spark plug from the cylinder. Connect the spark plug cord and place it on the engine cylinder with its metal part touching the cylinder. Pull the starter and observe the spark at the spark plug electrode. If there is none, repeat the test with a new spark plug.
- Press the primer bulb until fuel is visible in the bulb. If fuel is not visible, it means that the primary fuel supply system is blocked. Contact a **TRUPER®** Authorized Service Center. If the primer bulb fills with fuel, it indicates that the engine is flooded.
- With the ignition switch turned off, remove the spark plug. Move the choke lever up and pull the starter handle 15 to 20 times to remove excess fuel from the engine. Clean the spark plug and reinstall it. Follow the normal starting procedure (see page 8). If the engine does not start, move the choke lever down and repeat the starting procedure. If the engine still does not start, repeat the procedure with a new spark plug.
- Take the tool to a **TRUPER®** Authorized Service Center.

The engine starts but does not accelerate.

- The engine requires a few minutes to warm up.

- Allow the engine to warm up completely. If the engine does not accelerate after three minutes, contact your **TRUPER®** Authorized Service Center.

The engine starts but only runs at high speed with half the choke.

- The carburetor requires adjustment.

- Take the tool to a **TRUPER®** Authorized Service Center.

The engine does not reach full speed and emits too much smoke.

- Check the oil/fuel mixture.
- The air filter is dirty.
- The spark arrestor screen is dirty.

- Use new fuel and the correct 2-stroke oil mixture.
- Clean the air filter. See page 10.
- Clean the spark arrestor screen as indicated on page 10.

The engine starts, runs, and accelerates but does not have idle.

- The idle screw on the carburetor needs adjustment.

- Take the machine to a **TRUPER®** Authorized Service Center.

If problems persist despite performing the recommended corrective actions, contact a **TRUPER®** Authorized Service Center.

In the event of any problem contacting a **TRUPER** Authorized Service Center, please see our webpage WWW.TRUPER.COM to get an updated list, or call our toll-free numbers 800 690-6990 or 800-018-7873 to get information about the nearest Service Center.

AGUASCALIENTES **DE TODO PARA LA CONSTRUCCIÓN**
GRAL. BARRAGÁN #1201, COL. GREMIAL, C.P. 20030,
AGUASCALIENTES, AGS. TEL.: 449 994 0537

BAJA CALIFORNIA **SUCURSAL TIJUANA**
AV. LA ENCANTADA, LOTE #5, PARQUE INDUSTRIAL EL
FLORIDO II, C.P. 22244, TIJUANA, B.C.
TEL.: 664 969 5100

BAJA CALIFORNIA SUR **FIX FERRETERÍAS**
FELIPE ÁNGELES ESQ. RUIZ CORTÍNEZ S/N, COL. PUEBLO
NUEVO, C.P. 23670, CD. CONSTITUCIÓN, B.C.S.
TEL.: 613 132 1115

CAMPECHE **TORNILLERÍA Y FERRETERÍA AAA**
AV. ÁLVARO OBREGÓN #324, COL. ESPERANZA
C.P. 24080 CAMPECHE, CAMP. TEL.: 981 815 2808

CHIAPAS **FIX FERRETERÍAS**
AV. CENTRAL SUR #27, COL. CENTRO, C.P. 30700,
TAPACHULA, CHIS. TEL.: 962 118 4083

CHIHUAHUA **SUCURSAL CHIHUAHUA**
AV. SILVESTRE TERRAZAS #128-11, PARQUE INDUSTRIAL
BAFAR, CARRETERA MÉXICO CUAUHTÉMOC, C.P. 31415,
CHIHUAHUA, CHIH. TEL.: 614 434 0052

MEXICO CITY **FIX FERRETERÍAS**
EL MONSTRUO DE CORREGIDORA, CORREGIDORA # 35,
COL. CENTRO, C.P. 06060, CUAUHTÉMOC, CDMX.
TEL.: 55 5522 5031 / 5522 4861

COAHUILA **SUCURSAL TORREÓN**
CALLE METAL MECÁNICA #280, PARQUE INDUSTRIAL
ORIENTE, C.P. 27278, TORREÓN, COAH.
TEL.: 871 209 68 23

COLIMA **BOMBAS Y MOTORES BYMTESA DE MANZANILLO**
BLVD. MIGUEL DE LA MADRID #190, COL. 16 DE
SEPTIEMBRE, C.P. 28239, MANZANILLO, COL.
TEL.: 314 332 1986 / 332 8013

DURANGO **TORNILLOS ÁGUILA, S.A. DE C.V.**
MAZURIO #200, COL. LUIS ECHEVERRÍA, DURANGO,
DGO. TEL.: 618 817 1946 / 618 818 2844

ESTADO DE MÉXICO **SUCURSAL CENTRO JILOTEPEC**
PARQUE INDUSTRIAL # 1, COL. PARQUE INDUSTRIAL
JILOTEPEC, JILOTEPEC, EDO. DE MÉX. C.P. 54257
TEL.: 761 782 9101 EXT. 5728 Y 5102

GUANAJUATO **CÍA. FERRETERA NUEVO MUNDO S.A. DE C.V.**
AV. MÉXICO - JAPÓN #225, CD. INDUSTRIAL, C.P. 38010,
CELAYA, GTO. TEL.: 461 617 7578 / 79 / 80 / 88

GUERRERO **CENTRO DE SERVICIO ECLIPSE**
CALLE PRINCIPAL MZ 1 LT. 1, COL. SANTA FE, C.P. 39010,
CHILPANCIÑO, GRO. TEL.: 747 478 5793

HIDALGO **FERRETERÍAS S.A. DE C.V.**
LIBERTAD ORIENTE #304 LOCAL 50, INTERIOR DE PASAJE
ROBLEDO, COL. CENTRO, C.P. 43600, TULANCINGO,
HGO. TEL.: 775 753 6615 / 775 753 6616

JALISCO **SUCURSAL GUADALAJARA**
AV. ADOLFO B. HORN # 6800, COL. SANTA CRUZ DEL
VALLE, C.P.: 45655, TLAJOMULCO DE ZUÑIGA, JAL.
TEL.: 33 3606 5285 AL 90

MICHOACÁN **FIX FERRETERÍAS**
AV. PASEO DE LA REPÚBLICA #3140-A, COL.
EX-HACIENDA DE LA HUERTA, C.P. 58050, MORELIA,
MICH. TEL.: 443 334 6858

MORELOS **FIX FERRETERÍAS**
CAPITÁN ANZURES #95, ESQ. JOSÉ PERDIZ, COL.
CENTRO, C.P. 62740, CUAUTLA, MOR.
TEL.: 735 352 8931

NAYARIT **HERRAMIENTAS DE TEPIC**
MAZATLAN #117, COL. CENTRO, C.P. 63000, TEPIC, NAY.
TEL.: 311 258 0540

NUEVO LEÓN **SUCURSAL MONTERREY**
CARRETERA LAREDO #300, 1B MONTERREY PARKS,
COLONIA PUERTA DE ANAHUAC, C.P. 66052, ESCOBEDO,
NUEVO LEÓN, TEL.: 81 8352 8791 / 81 8352 8790

OAXACA **FIX FERRETERÍAS**
AV. 20 DE NOVIEMBRE #910, COL. CENTRO, C.P. 68300,
TUXTEPEC, OAX. TEL.: 287 106 3092

PUEBLA **SUCURSAL PUEBLA**
AV. PERIFÉRICO #2-A, SAN LORENZO ALMECATLA,
C.P. 72710, CUAUHTLACINGO, PUE.
TEL.: 222 282 8282 / 84 / 85 / 86

QUERÉTARO **ARU HERRAMIENTAS S.A. DE C.V.**
AV. PUERTO DE VERACRUZ #110, COL. RANCHO DE
ENMEDIO, C.P. 76842, SAN JUAN DEL RÍO, QRO.
TEL.: 427 268 4544

QUINTANA ROO **FIX FERRETERÍAS**
CARRETERA FEDERAL MZ. 46 LT. 3 LOCAL 2, COL. EJIDAL,
C.P. 77710 PLAYA DEL CARMEN, Q.R.
TEL.: 984 267 3140

SAN LUIS POTOSÍ **FIX FERRETERÍAS**
AV. UNIVERSIDAD #1850, COL. EL PASEO, C.P. 78320,
SAN LUIS POTOSÍ, S.L.P. TEL.: 444 822 4341

SINALOA **SUCURSAL CULIACÁN**
AV. JESÚS KUMATE SUR #4301, COL. HACIENDA DE LA
MORA, C.P. 80143, CULIACÁN, SIN.
TEL.: 667 173 9139 / 173 8400

SONORA **FIX FERRETERÍAS**
CALLE 5 DE FEBRERO #517, SUR LT. 25 MZ. 10, COL.
CENTRO, C.P. 85000, CD. OBREGÓN, SON.
TEL.: 644 413 2392

TABASCO **SUCURSAL VILLAHERMOSA**
CALLE HELIO LOTES 1, 2 Y 3 MZ. #1, COL. INDUSTRIAL,
2A ETAPA, C.P. 86010, VILLAHERMOSA, TAB.
TEL.: 993 353 7244

TAMAULIPAS **VM ORINGS Y REFACCIONES**
CALLE ROSITA #527 ENTRE 20 DE NOVIEMBRE Y GRAL.
RODRÍGUEZ, FRACC. REYNOSA, C.P. 88780, REYNOSA,
TAMS. TEL.: 899 926 7552

TLAXCALA **SERVICIOS Y HERRAMIENTAS INDUSTRIALES**
PABLO SIDAR #132, COL. BARRIO DE SAN BARTOLOMÉ,
C.P. 90970, SAN PABLO DEL MONTE, TLAX.
TEL.: 222 271 7502

VERACRUZ **LA CASA DISTRIBUIDORA TRUPER**
BLVD. PRIMAVERA ESQ. HORTENSIA S/N, COL.
PRIMAVERA, C.P. 93308, POZA RICA, VER.
TEL.: 782 823 8100 / 826 8484

YUCATÁN **SUCURSAL MÉRIDA**
CALLE 33 #600 Y 602, LOCALIDAD ITZINCAB Y MULSA,
MPIO. UMAN, C.P. 97390, MÉRIDA, YUC.
TEL.: 999 912 2451

Code	Model	Brand
103204	AHO-52	TRUPER®

Warranty. Duration: 1 year. Coverage: parts, components and workmanship against manufacturing or operating defects, except if used under conditions other than normal; when it was not operated in accordance with the instructive; was altered or repaired by personnel not authorized by TRUPER®. To make the warranty valid, present the product, stamped policy or invoice or receipt or voucher, in the establishment where you bought it or in Corregidora 35, Centro, Cuauhtémoc, CDMX, 06060, where you can also purchase parts, components, consumables and accessories. It includes the costs of transportation of the product that derive from its fulfillment of its service network. . Phone number 800-018-7873. Made in China. Imported by TRUPER, S.A. de C.V. Parque Industrial 1, Parque Industrial Jilotepec, Jilotepec, Edo. de Méx. C.P. 54257, Phone number 761 782 9100.

Stamp of the business. Delivery date:

